

[illegible]

DATE:	07/17/24
DRAWN BY:	ZH
CHECKED BY:	DAS
FIELD BOOK:	1136

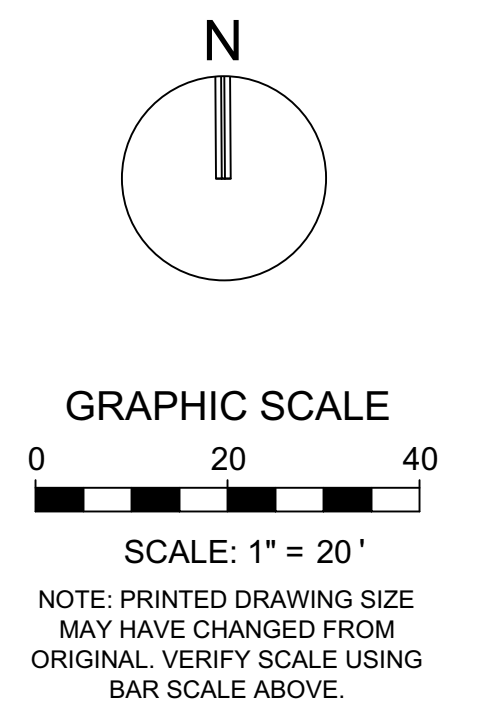

2851 DR. MARTIN
LUTHER KING BLVD.

PORTIONS OF THE SE 1/4 OF
THE SE 1/4 OF THE SW 1/4
OF SECTION 28, TOWNSHIP
48 SOUTH, RANGE 42 EAST
AND
A PORTION OF PARCEL "A",
WALTON SITE
P.B. 138, PG. 42, B.C.R.

CITY OF POMPANO BEACH,
BROWARD COUNTY,
FLORIDA

SHEET TITLE

TOPOGRAPHIC
SURVEY

SHEET
NUMBER SHEET 2 OF 2

PROJECT NUMBER	14232.00
----------------	----------



This form has been digitally signed and verified by DONALD A. Spicer on this date, below using a Digital Signature.

Printed copies of this document are not considered signed and sealed until the signature must be verified on any electronic copies.

Digitally signed by DONALD A. SPICER
Date: 2024.08.06 09:22:19-04'00'